

Whereas second Addition to Margarette Rowan begins 366 feet east of the
 north west corner of the north west quarter of the south west quarter of Sec. 24
 T. 21 N. R. 20 E. and ranges west or the south east corner Rowan's
~~lot~~ ^{lot} 11 blocks to Margarette Rowan. Thence east 1015 feet, thence
 north 900 feet, thence west 1015 feet, thence south 504 feet to the place of
 beginning

H. A. Rowland County Surveyor

[Signature]

Margarette Rowan by 11.

To whom it may concern be this
 undesignated being the owner of the land upon which Rowan's 2nd
 Addition to Margarette Rowan is situated hereby certify that we have
 caused the same to be platted in accordance with the following plat
 and that we dedicate the streets and alleys to the use of the public
 in witness whereof we have signed this 29th day of June 1906.

G. W. Hanson
 N. M. Arroll
 Witnesses

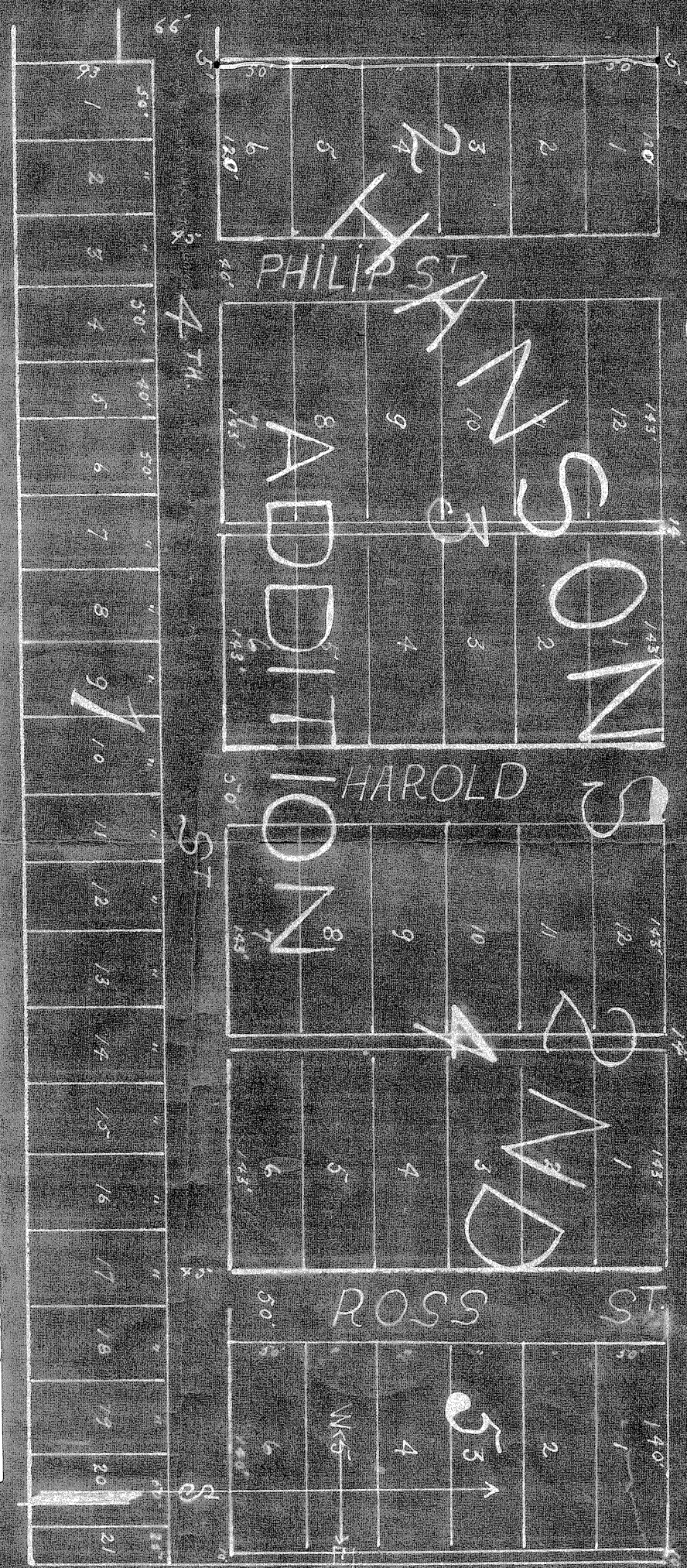

Witness to signature & mark,
 G. W. Hanson
 N. M. Arroll

State of Kansas, McPherson Co., ss.
 This Instrument was filed for record
 on the 2nd day of July A. D. 1906
 at 10 o'clock, A. M.
 Plat No. 3 on page 3
 Chas. H. Keebick
 Register of Deeds.

State of Kansas, McPherson County, ss.

1916